



# Battioni Pagani Pompe S.p.A.

via Marconi n.75-43058 SORBOLO-Parma-Italia  
Tel.0521/698241/2-Telex 531688BPPUMP I-Telefax n.0521/698742

CATALOGO

N.902

TAV.R 181

## POMPA DI RAFFREDDAMENTO E LUBRIFICAZIONE AUTOMATICA

### WPT 600 - 720 DFR - PFR - HFR

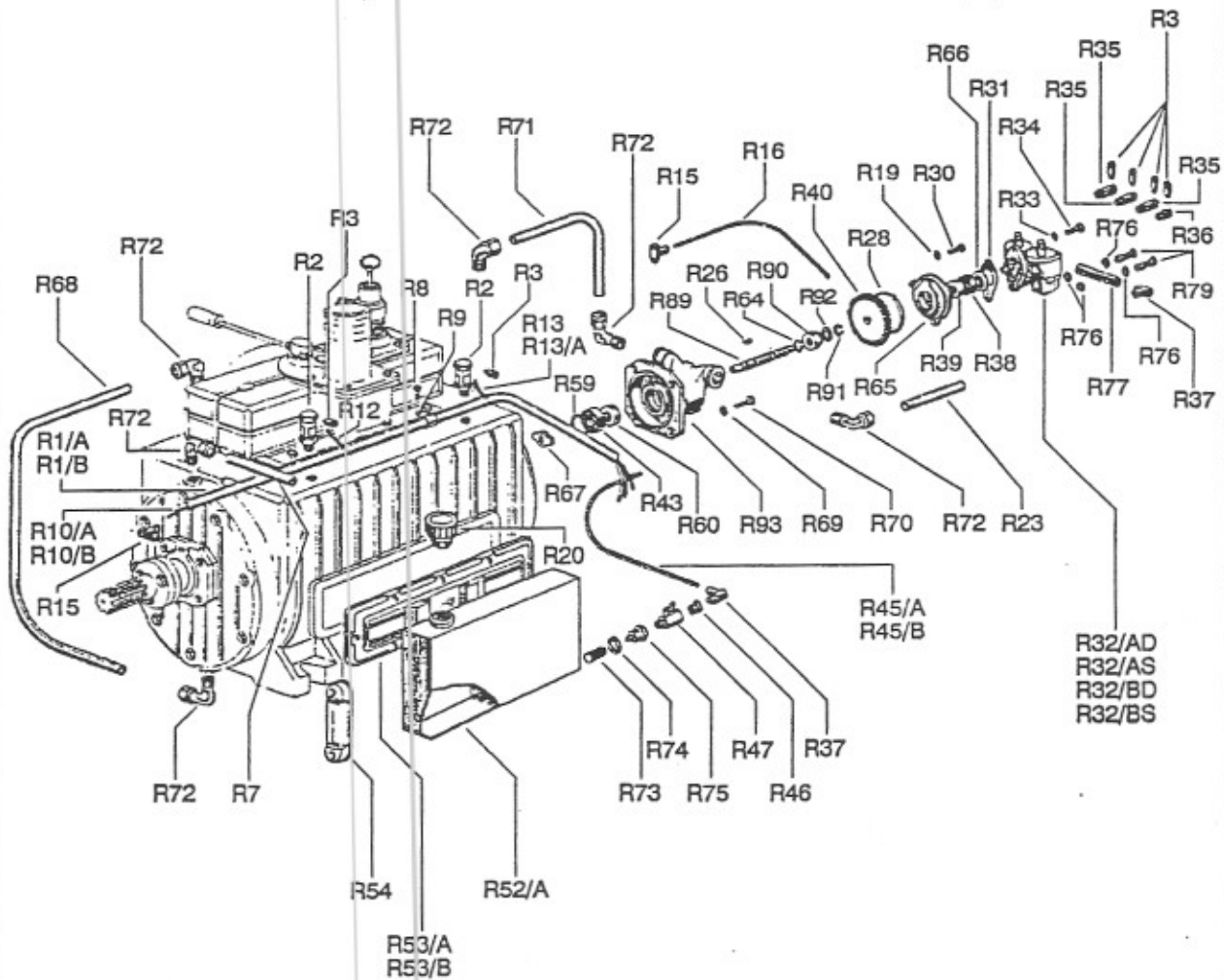

I dati e le misure sono solo indicative.  
These data and sizes are given just as an indication.  
Daten u. Masse sind unverbindlich.  
Les données et les mesures ne sont qu'à titre indicatif.

## WPT 480 – 600 – 720 Replacement Parts

DESCRIPTION	PART #	PRICE (US\$)
Water Jacket Cover - WPT 480 - Oil Tank Mount	R53	44.55
Water Jacket Cover - WPT 600 - Oil Tank Mount	R53/A	55.04
Water Jacket Cover - WPT 720 - Oil Tank Mount	R53/B	59.44
Repair Kit - WPT 480/P - 4 Vane Type	W0/P4	497.95
Repair Kit - WPT 480/P - 4 Vane Type (L.Br)	W0/P4-B	644.04
Repair Kit - WPT 480/P - 6 Vane Type	W0/P6	490.57
Repair Kit - WPT 480/P - 6 Vane Type (L.Br)	W0/P6-B	674.82
Repair Kit - WPT 600/P	WP0/P	481.29
Repair Kit - WPT 600/P (Less Bearings)	WP0/P-B	683.91
Repair Kit - WPT 720/P - 4 Vane Type	WPT0/P4	490.38
Repair Kit - WPT 720/P - 4 Vane Type (L.Br)	WPT0/P4-B	513.62
Repair Kit - WPT 720/P - 6 Vane Type	WPT0/P-6	720.09
Repair Kit - WPT 720/P - 6 Vane Type (L.Br)	WPT0/P6-B	61.02
WPT Thermometer	W-180204	982.76
Housing - WPT 480	W1/F	403.45
Housing - WPT 600	WP1/F	524.14
Housing - WPT 720	WPT1/F	784.28
Rotor - WPT 480/P	W5/P	400.10
Rotor - WPT 600/P	WP5/P	515.86
Rotor - WPT 720/P	WPT5/P	710.48
Vane - WPT 480 - 4 Vane	W7-4	65.88
Vane - WPT 480 - 6 Vane	W7-6	71.01
Vane - WPT 600	WP7	27.30
Vane - WPT 720 - 4 Vane	WPT7-4	10.81
Vane - WPT 720 - 6 Vane	WPT7-6	0.71
Nut (M12)	W9	0.32
Bolt (M8 X 16)	W11	0.41
Gasket	W13	4.50
Handle Knob	W15	0.21
Washer (10)	W17	6.37
Seal (52 X 68 X 10)	W18D	6.18
Seal (65 X 85 X 10)	W18/P	0.27
Bolt (M8 X 20)	W19	0.21
Washer (8)	W20	30.90
Receptacle	W22	82.07
Air Inlet (80mm)	W31	0.32
Bolt (M.8 X 25)	W34	8.10
Handle Rod	W35	

2670 Aero Park Drive • P.O. Box 685 • Traverse City, MI 49685-0685 • USA

## WPT 480 – 600 – 720 Replacement Parts (cont.)

DESCRIPTION	PART #	PRICE (US\$)
Exhaust Gasket	W36	8.00
Gasket	W37	4.00
4-Way Valve Housing	W38	44.00
Gasket	W39	4.00
Seal (35 X 50 X 7)	W40	2.25
Bolt (M10 X 25)	W41	0.40
Gasket	W42	2.25
Oil Plug (1/2" Gas)	W44	1.00
Spring	W46	1.00
Fitting - Pressure Relief	W49	33.50
Gasket	W50	1.40
Water Jacket Cover - WPT 480	W53	32.00
Water Jacket Cover - WPT 600	WP53	37.20
Water Jacket Cover - WPT 720	WPT53	42.20
Gasket - WPT 480	W54	1.30
Gasket - WPT 600	WP54	2.00
Gasket - WPT 720	WPT54	3.00
O-Ring	W74	2.50
4-Way Valve Housing	W77	399.00
4-Way Valve Cover	W78	42.00
Gasket	W79	2.15
Bolt (M10 X 45)	W80	0.70
Seal (45 X 62 X 12)	W81/PN	7.33
Seal (45 x 85 x 10)	W81/PO	7.33
Non-Return Ball (100mm)	W82	56.55
Rear End Plate	W83/F	450.69
End Plate Gasket (Front & Rear)	W84	1.39
Bolt (M10 X 70)	W85	1.25
Bearing (NJ2309)	W86	110.27
Air Horn	W87	51.95
Flange Clamping	W88	44.79
Bearing (NJ309)	W93	33.26
Bearing Cover - Front	W95	34.71
Front End Plate	W96	462.93
Key (10 X 8 X 80)	W97	2.43
Plug	W102	12.60
Seal Sleeve (65 X 52 X 30)	W103	40.55
Seal Sleeve (65 X 52 X 36)	W104	45.93