

12" LOW PROFILE PRIMARY



- MINIMIZES OVERALL VACUUM TANK HEIGHT (ONLY 7.25" TALL)
- WELDABLE BASE IS 12.25 O.D.
- STANDARD NECK LENGTH OF 6"
- POSITIVE SHUTOFF WITH 6" OR 8" STAINLESS STEEL BALL
- EASY ACCESS FOR QUICK CLEAN OUT
- HEAVY DUTY ZINC PLATED HARDWARE



*THIS ITEM CAN ALSO BE SPECIAL ORDERED WITH A 12" NECK. PLEASE CALL FOR DETAILS

PRIMARY SHUTOFFS

PART#	DESCRIPTION	WEIGHT
1014-0900	12" LOW PROFILE PRIMARY SHUTOFF WITH 6" NECK EQUIPPED WITH 3" PIPE WITH OPENING, (450 CFM)	60 LBS
1014-0901	12" LOW PROFILE PRIMARY SHUTOFF WITH 6" NECK EQUIPPED WITH 3" NPT THREADS, (450 CFM)	61 LBS
1014-0901 HS	12" LOW PROFILE PRIMARY SHUTOFF WITH 6" NECK EQUIPPED WITH 3" HOSE SHANK (450 CFM)	62 LBS
1014-0910	12" LOW PROFILE PRIMARY SHUTOFF WITH 6" NECK EQUIPPED WITH 4" PIPE WITH OPENING, (525 CFM)	66 LBS
1014-0911	12" LOW PROFILE PRIMARY SHUTOFF WITH 6" NECK EQUIPPED WITH 4" NPT THREADS, (525 CFM)	67 LBS
1014-0914	12" LOW PROFILE PRIMARY SHUTOFF WITH 6" NECK EQUIPPED W/4" PIPE & OPENING INCLUDES 10" BALL CAGE & 8" S.S. BALL	77 LBS

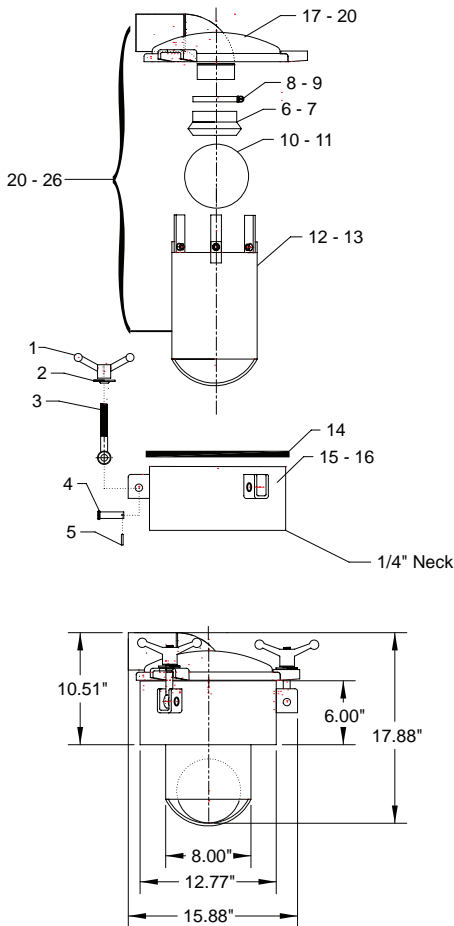

12" LOW PROFILE PRIMARY SPEC

#	PART#	DESCRIPTION
REPLACEMENT PARTS		
1	1010-0001	5/8" ZINC PLATED WING NUT (2LBS)
2	1010-0003	ZINC WASHER (.188LBS)
3	1021-0000-B	5/8" X 5" ZINC PLATED EYEBOLT (.80LBS)
4	1021-0000-P	ZINC PLATED CLEVIS PIN (.19LBS)
5	1021-0000-R	ZINC PLATED ROLL PIN (.06LBS)
6	1090-0000	3.5" RUBBER SEAT (2LBS)
7	1089-0001	4" I.D. RUBBER SEAT
8	1090-0001	HOSE CLAMP FOR 1090 SEAT
9	1089-0002	HOSE CLAMP FOR 1089-1 SEAT
10	1076-0000	6" STAINLESS STEEL FLOAT BALL
11	1076-0003	8" STAINLESS STEEL FLOAT BALL
12	1014-0950	8" STAINLESS STEEL BALL CAGE
13	1014-0604	10" STAINLESS STEEL BALL CAGE
14	1019-0009	GASKET FOR 12" MANWAY
15		SEE POSITION # 8 ON PG 42
16		SEE POSITION # 8 ON PG 42
17	1014-0907	12" LOW-PROFILE LID WELDMENT, 3" PIPE
18	1014-0909	12" LOW-PROFILE LID WELDMENT, 3" THREADS
19	1014-0921	12" LOW-PROFILE LID WELDMENT, 4" PIPE
20	1014-0922	12" LOW-PROFILE LID WELDMENT, 4" THREADS
21	1014-0906	12" LOW-PROFILE LID ASSY, 3" PIPE
22	1014-0908	12" LOW-PROFILE LID ASSY, 3" THREADS
23	1014-0917	12" LOW-PRO LID ASSY, 8" CAGE, 4" PIPE
24	1014-0918	12" LOW-PRO LID ASSY, 10" CAGE, 4" PIPE
25	1014-0919	12" LOW-PRO LID ASSY, 8" CAGE, 4" THREADS
26	1014-0920	12" LOW-PRO LID ASSY, 10" CAGE, 4" THREADS

SEE LIST OF OPTIONAL FITTINGS ON PAGE 38, 47 & 51.