

21" MANWAY (5 WING NUT)



- GASKET IN THE NECK DESIGN
- RIGHT OR LEFT HINGE MODELS
- STANDARD NECK LENGTHS OF 6 OR 12 INCHES
- 1/4" STEEL CONSTRUCTION
- WELDABLE BASE IS 21.25" O.D.

PART#	DESCRIPTION	L x W x H	WEIGHT
LEFT HAND HINGE TYPE			
1010-0024	21" MANWAY WITH 6" NECK, 1/4" BASE	27x27x10.5	76LBS
1011-0024	21" MANWAY WITH 12" NECK, 1/4" BASE	27x27x16.5	105LBS
RIGHT HAND HINGE TYPE			
1010-0027	21" MANWAY WITH 6" NECK, 1/4" BASE	27x27x10.5	76LBS
1011-0027	21" MANWAY WITH 12" NECK, 1/4" BASE	27x27x16.5	105LBS

21" MANWAY (5 WING NUT) SPEC

#	PART#	DESCRIPTION
REPLACEMENT PARTS		
1	1010-0001	5/8" ZINC PLATED WING NUT (2LBS)
2	1010-0003	ZINC WASHER (.188LBS)
3	1021-0000-B	5/8" X 5" ZINC PLATED EYEBOLT (.80LBS)
4	1021-0000-P	ZINC PLATED CLEVIS PIN (.19LBS)
5	1021-0000-R	ZINC PLATED ROLL PIN (.06LBS)
6	1021-0000-HP	ZINC PLATED HINGE PIN (.44LBS)
7	1010-0009	GASKET FOR 21" MANWAY
8	1011-2600	21" MANWAY LID ASSY, LEFT HAND HINGE
9	1011-2601	21" MANWAY LID ASSY, RIGHT HAND HINGE
10	1010-2507	21" BASE, 6" X 1/4" NECK W/SWN LEFT HAND HINGE
11	1010-2509	21" BASE, 6" X 1/4" NECK W/SWN RIGHT HAND HINGE
12	1010-2513	21" BASE, 12" X 1/4" NECK W/SWN LEFT HAND HINGE
13	1010-2515	21" BASE, 12" X 1/4" NECK W/SWN RIGHT HAND HINGE

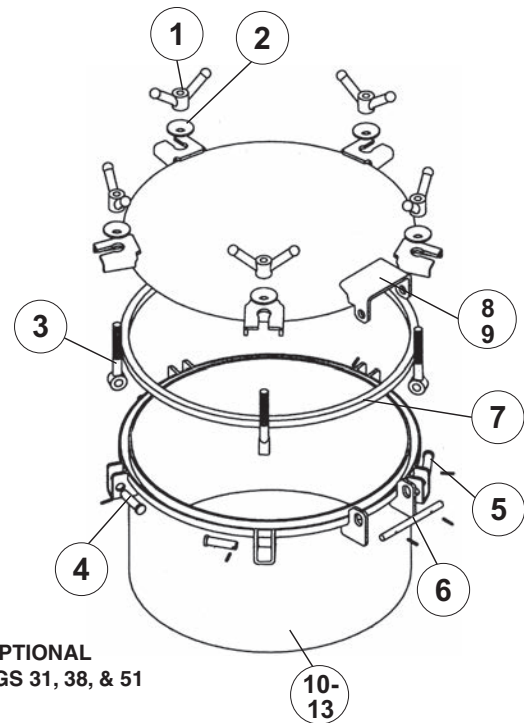

*SEE LIST OF OPTIONAL FITTINGS ON PGS 31, 38, & 51

